

GAME ASSEMBLY

1. Unfold and pop out all pieces of the sheet (1,2), push out all slots of the tree.



2. Take both sides (1,2) of the tree, make sure the colours match up and slot them together.



3. Once assembled, take the two inserts (3,4) and slot them in.

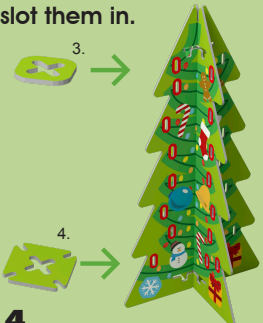

4. Once slotted in, push down inserts (3,4) to keep the tree in place.

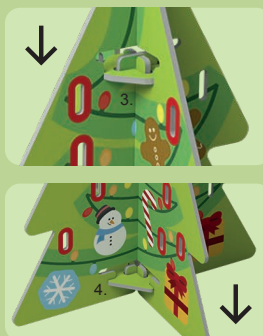

5. Take the star sides (5,6) and slot them together.

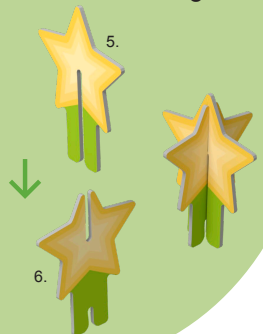

www.tomy.com

TOMY Europe
Hembury House, Exeter, EX2 5AZ, UK
(TOMY Europe is the trading name of TOMY UK Co., Ltd)
Tel: 01702 208155
Email: question@TOMYcare.co.uk

See more great games at
www.drumondpark.com

©2019 Drumond Games Ltd
All photographs and images used © / Adobe Stock
Colour and contents may vary from those shown.
Please retain this packaging for future reference,
Made in Netherlands.



WARNING! Not suitable for children under 36 months due to small parts.
CHOKING HAZARD.



Ref No. T72989

2180 - 150419



...cracking Christmas trivia for all the family

The BEST of CHRISTMAS GAME

A Game for 2 teams.
Players aged 12+

CONTENTS

Christmas Tree Playing Board, 55
Question Cards, 32 Decoration Pieces
and Rules.

PREPARING TO PLAY

Assemble the Christmas Tree playing boards
as shown. Lay the deck of cards in a handy
pile with the question sides down. Each
team takes 16 decoration pieces (these can
be any of the different pieces).

QUESTIONS

There are three kinds of Question Card:

- **Picture Cards** – questions relate to the picture on the front.
- **Pot Luck Cards** – questions are random.
- **“Theme” Cards** – questions all relate to a common theme printed on the card back.

THE BOARD

The Christmas Tree board has four “sides”. Two of these have a series of holes rising from the bottom to the top. The teams are racing to hang up all their decorations - starting at the bottom hole and rising to the top, as they answer questions correctly. Each time a question is answered correctly a decoration is “hung” into the next hole up.

START PLAY

The team with the youngest player plays first. The oldest player from the other team becomes Question Master (QM) for the first turn. Members of the ‘non-playing’ team take turns at being the QM.

ANSWERING CORRECTLY

The QM takes the first card from the pile and asks the first question to the playing team. If the question card is a Picture Card or Theme Card the QM shows the back of the card (the picture side) to the playing team – whilst hiding the answers from his own team.

If the playing team answers correctly they immediately hang a decoration in the lowest hole on their side of the tree.

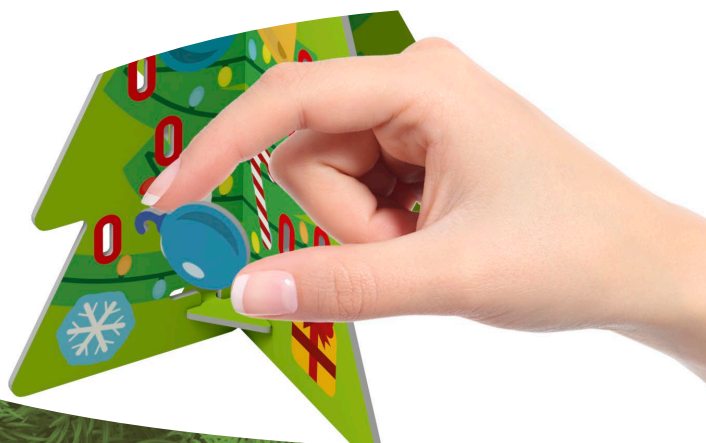

The QM goes on to ask the team the remaining questions on the card. Each time the team answers a question correctly they hang another decoration in the next available hole, making their way up the tree. Once the team has answered the fourth question (right or wrong) their turn is over and the card is placed to the bottom of the pile.

WRONG ANSWERS

If the playing team gets a question wrong, the QM asks the SAME question to their own team. If they get it right, they win a bonus decoration to be added to their side of the tree. The QM now continues to ask the remaining questions on the card to the playing team.

TO WIN

When a team answers a question correctly and hangs their final decoration on the tree they put the Star on the top of the tree and win the game.

